

School of International and Public Affairs Florida International University

For ASB Program Information, visit
[www.florida-arts.org/programs/
statebuildings](http://www.florida-arts.org/programs/statebuildings)

BUDGET: \$80,000

PROJECT: BT-835 School of International and Public Affairs,
Florida International University, Miami, FL

Deadline: Monday October 31, 2011 (received by 5 PM)

Florida International University is Miami–Dade County’s first public, four–year university. As one of South Florida’s anchor institutions, FIU has been locally and globally engaged for more than four decades finding solutions to the most challenging problems of our time.



HISTORY AND GROWTH:

FIU opened for classes in 1972 with 5,667 students - the largest opening day enrollment in U.S. collegiate history. Today it has more than 44,000 students, 1,000+ full-time faculty and more than 160,000 alumni. FIU is one of the 25 largest universities in the nation, based on enrollment.

RESEARCH:

FIU emphasizes research as a major component of its mission. Sponsored research funding (grants and contracts) from external sources for the year 2008-2009 totaled approximately \$101 million.

ARTS & CULTURE:

In recent years, FIU has emerged as one of South Florida’s major cultural assets, offering programs to both students and the local community. Several of its programs are nationally renowned for their excellence. The Patricia & Phillip Frost Art Museum celebrated its grand opening in 2008 -<http://thefrost.fiu.edu/>. The Wolfsonian-FIU, located in Miami Beach, promotes the collection, preservation and understanding of decorative art and design from the period 1885-1945. The Chaplin School of Hospitality and Tourism Management helps present the annual South Beach Wine & Food Festival, one of the major culinary events in the nation.

For more information on the University please visit, www.fiu.edu

Mail Submissions to:

Art in State Buildings
Attn: Carol Damian, Alexander
Garcia
Frost Art Museum
10975 SW 17th Street
Miami, FL 33199

Project Inquiries:

Carol Damian
damianc@fiu.edu
or
Alexander Garcia
aogarcia@fiu.edu

Website:

[http://thefrost.fiu.edu/artinstate
.html](http://thefrost.fiu.edu/artinstate.html)

ABOUT THE COLLEGE:

School of International and Public Affairs

Florida International University's School of International and Public Affairs (SIPA) was established in 2009 to bring sharper focus to the University's highly-regarded programs in politics, international relations, geography, public administration, and sociology and anthropology. The School's vision is to be one of the nation's premier centers for research, education and training in the fields of international affairs and governance and to be an essential resource for analysis and consulting for government, not-for-profit and for-profit organizations alike.

In spring 2011, the School moved into a new, architecturally dazzling and technologically state-of-the art building at the center of FIU's Modesto A. Maidique Campus.

An Internationally-focused Community and University

Florida International University has had an international focus ever since it opened its doors in 1972. As South Florida's public research university, FIU mirrors not only the multicultural character of its community but also the region's hemispheric and increasingly global outlook and economic impact.

As FIU approaches the 40th anniversary of its founding, its international orientation has emerged as the clear and distinguishing academic characteristic of the University. More than 60 percent of all classes at the University have an international component. Several of FIU's academic centers – including the Latin American and Caribbean Center, the Cuban Research Institute, the Miami European Union Center, and the Asian Studies and Middle East Studies programs – have established national and international reputations. FIU's College of Business Administration has one of the nation's strongest graduate and undergraduate programs in international business, its world-renowned School of Hospitality and Tourism Management has a campus in China, and its young College of Law is one of the nation's few law schools to embody an international component in virtually all its classes. FIU's schools, colleges and centers combine to provide one of the most comprehensive global approaches to international studies available in the United States.

FIU's College of Arts and Sciences is at the center of the University's international focus. Most of the international centers listed above are either located within the College or draw heavily on faculty in the College's 16 academic departments. The College of Arts and Sciences embraces 100 percent of the University's undergraduate majors and approximately 18 percent of its graduate students.

FIU's School of International and Public Affairs

As part of a reconceptualization of the College of Arts and Sciences to concentrate on the University's priority academic themes, in 2009 the College created the School of International and Public Affairs as a major academic unit within the College. SIPA brings together many of FIU's internationally-oriented disciplines and addresses the need for an interdisciplinary approach to understanding the globalized world of the 21st century.

SIPA's mission is to educate and train globally competent leaders in the field of international and public affairs; produce scholarship that advances the understanding of international issues while contributing to policy solutions; and promote international dialogue that fosters greater mutual understanding throughout the world.

The School's academic core consists of eight major interdisciplinary departments – Politics and International Relations, Global and Sociocultural Studies, Public Administration, Criminal Justice, Economics, History, Modern Languages and Religious Studies – with approximately 170 full-time faculty members and a combined enrollment of more than 4500 students. It offers innovative degree programs at both the graduate and undergraduate levels: doctoral degrees in 7 areas; 13 master's degrees, including a new Master of Arts in Global Governance that will be SIPA's signature professional master's degree program; 13 undergraduate majors, 13 undergraduate minors, and more than a dozen certificate programs at both the undergraduate and graduate levels. In addition, SIPA hosts 18 academic programs that support the educational and research efforts of its departments, faculty, and students. It also has four joint graduate degree programs in conjunction with FIU's College of Law and Chapman Graduate School of Business Administration.

SIPA's New Home

FIU has underscored its commitment to its international affairs programs by approving the construction of a two-phased, architecturally-distinctive \$45 million facility to house the School of International and Public Affairs. The first phase, funded by \$25 million in public funds, has been completed and opened in spring 2011.

The building, designed by the internationally-renowned and Miami-based architectural firm Arquitectonica, is an architectural showpiece for FIU and South Florida. The principal features of the 58,000 square foot Phase I are a two-story lobby and a two-story auditorium cantilevered 40 feet outward, with an energy-efficient green roof. It also includes a five-story tower that will house classrooms, language and technology labs, faculty offices, conference rooms, a suite for graduate students, and administrative space. Phase II, for which private funds are needed to fund construction, will add another five-story tower that will feature dedicated space for graduate students plus additional classroom and faculty office space.

The 480-seat Ruth K. and Shepard Broad Auditorium is the largest and most technologically-advanced academic space at FIU. It has multi-media, simultaneous translation capabilities for lectures and conferences on site, and is able to export, via the internet and other telecommunications media, any programs originating there with studio-like quality. The auditorium's 10,000 square foot green roof system – the largest in South Florida – is a key element in an energy-efficient design that is anticipated to achieve LEED Silver Certification.

POTENTIAL SITES FOR ARTWORK

The Committee has selected two potential places where artwork could possibly be sited. They may acquire artwork for one or more of those sites from one or more artists. The sites are listed below, in no particular order.

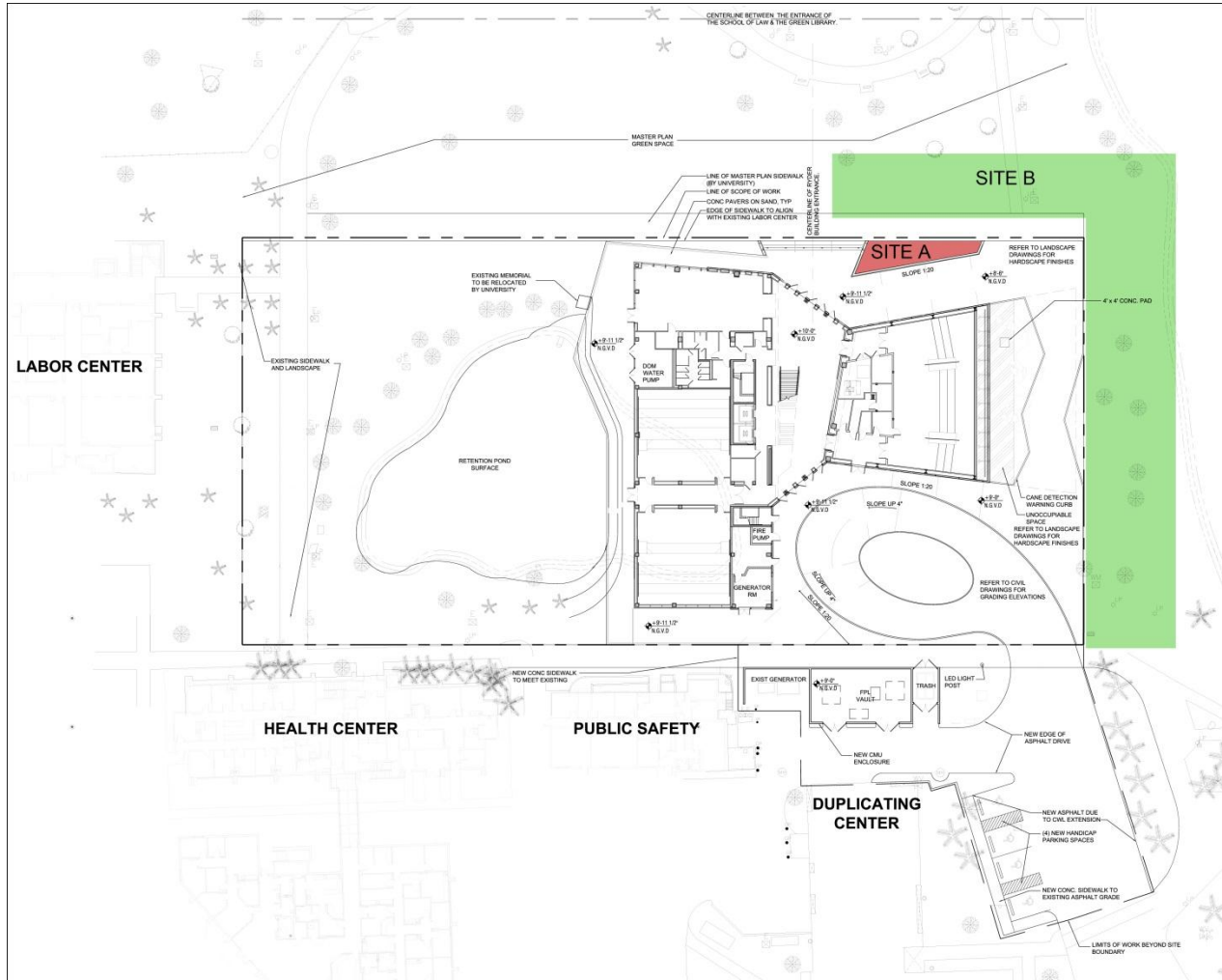

- A. North Side Entrance Planter**
- B. Outdoor landscape area adjacent to auditorium.**

If you feel your work is more appropriate for a particular site, you should tell the Committee which site or sites you prefer in your Artist Statement.

SITE A: North Side Entrance Planter



SITE B: Outdoor landscape area adjacent to auditorium.





Qualifications:

CRITERIA Participating artists must have reached a certain level of expertise and recognition in their medium. Their resumes should illustrate that they have met two of the following criteria:

1. The artist has completed other public commissions on a similar scale.
2. The artist has received awards, grants, or fellowships.
3. The artist's works are included in public, private, corporate, or museum collections.
4. The artist has participated in exhibitions at major museums or galleries.

Include in your submission:

All of these items are to be included in your submission form. Please don't send the information twice. Make sure you include:

1. A statement: a paragraph that explains why your artwork is perfect for this project and how the submitted images relate to the project requirements. This should not yet be a site-specific proposal.
2. A current professional resume, emphasizing public art experience, public collections and public commissions.
3. Digital Images: A minimum of 10 and a maximum of 15 digital images on a disposable CD that is clearly labeled with artist's name & the project name. Images should be in .JPG format with a minimum resolution of approximately 800x600 pixels (higher resolutions like 1900x1500 pixels provide sharper projected images).
- Each image file should be named with 1) artist's last name, 2) image number on ID Sheet and 3) artwork title (use representative words of a long title).

Any masking/borders should be black, not white. Artwork with sound or motion may be submitted as short MP3s. The first five artworks presented will receive initial review. Don't forget to provide the committee with details/close-ups of large or complex artworks.

4. Provide an image identification page that includes, 1) the image number, 2) a thumbnail image of the work, 3) title of work, 4) medium, 5) dimensions, 6) date of work, and 7) price of work or amount of commission.

Please note that submission materials will not be returned to applicants, so please do not send additional materials, such as catalogues, brochures, photographs, etc.